

DIMENSIONS

EM(R)-V

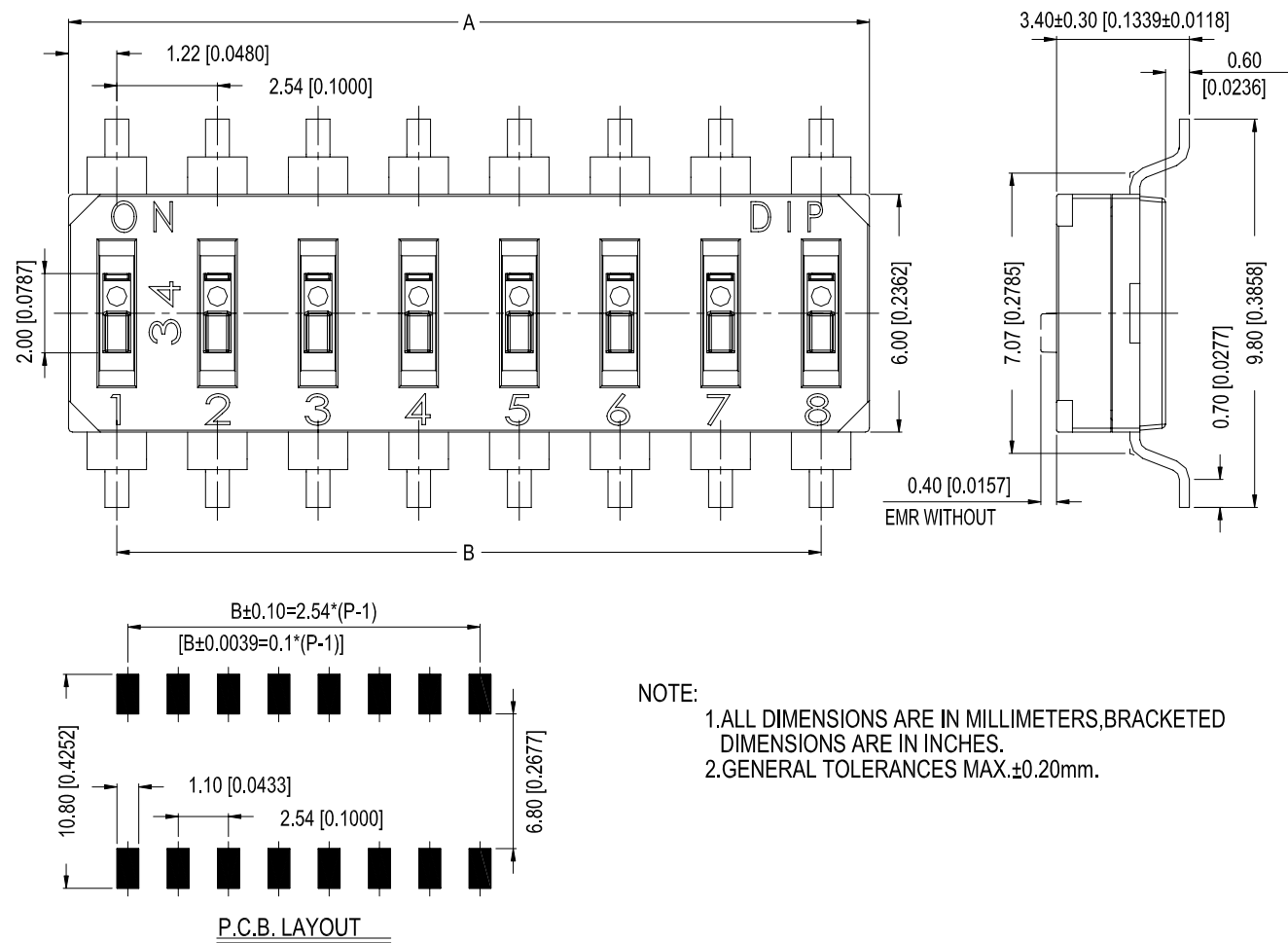

PROD. NO.	NO. OF POS.	DIM. A	DIM. B
EM-01-V EMR-01-V	1	2.44[.096]	
EM-02-V EMR-02-V	2	4.98[.196]	2.54[.100]
EM-03-V EMR-03-V	3	7.52[.296]	5.08[.100]
EM-04-V EMR-04-V	4	10.06[.396]	7.62[.300]
EM-05-V EMR-05-V	5	12.60[.496]	10.16[.400]
EM-06-V EMR-06-V	6	15.14[.596]	12.70[.500]
EM-07-V EMR-07-V	7	17.68[.696]	15.24[.600]
EM-08-V EMR-08-V	8	20.22[.796]	17.78[.700]
EM-09-V EMR-09-V	9	22.76[.896]	20.32[.800]
EM-10-V EMR-10-V	10	25.3[.996]	22.86[.900]
EM-12-V EMR-12-V	12	30.38[1.196]	27.94[1.100]

SCHEMATIC(TYP.)



(1,2,3,4,5,6,7,8,9,10,12,POS AVAIL)

EI(R)-V

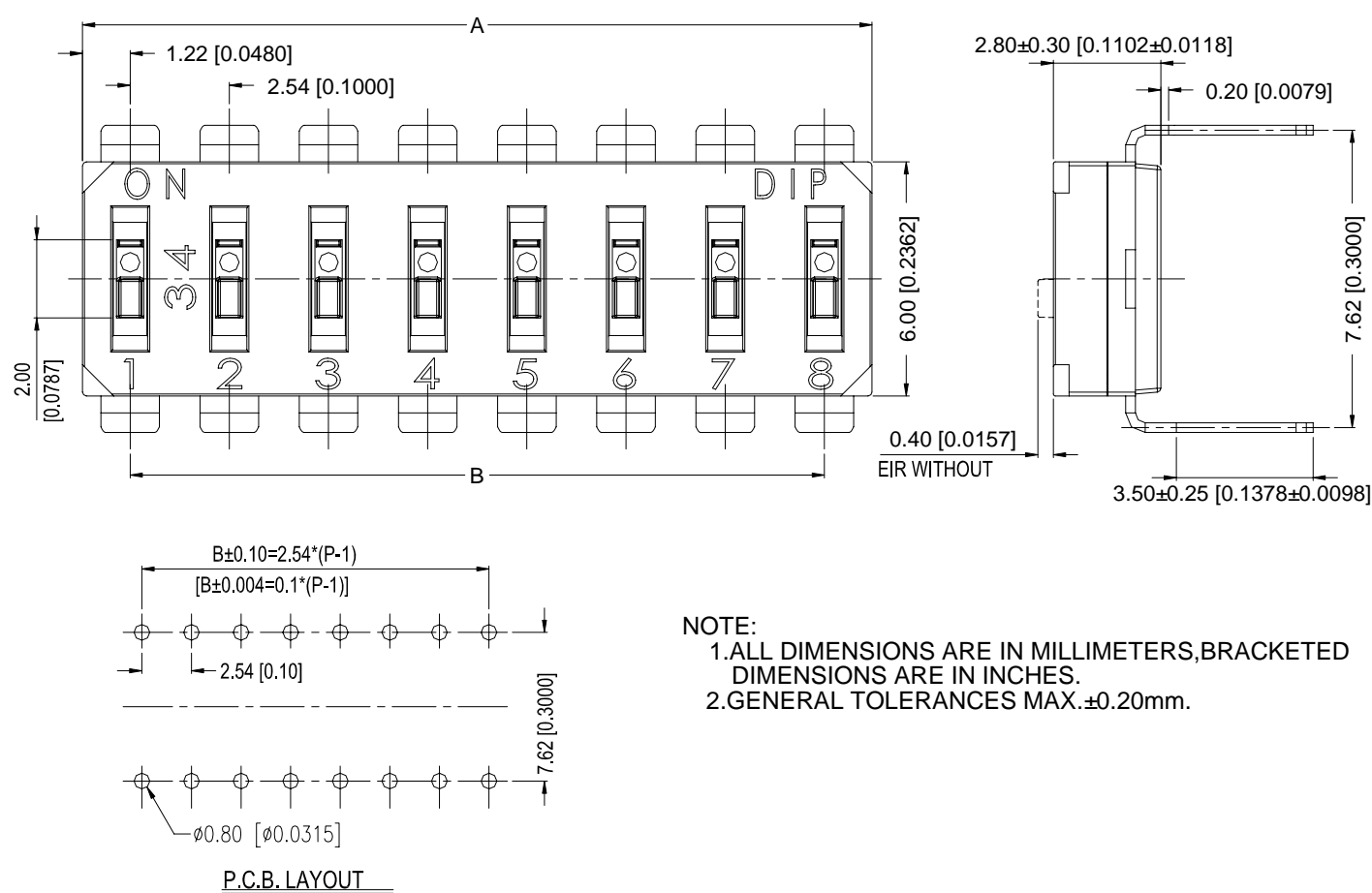

PROD. NO.	NO. OF POS.	DIM. A	DIM. B
EI-01-V EIR-01-V	1	2.44[.096]	
EI-02-V EIR-02-V	2	4.98[.196]	2.54[.100]
EI-03-V EIR-03-V	3	7.52[.296]	5.08[.100]
EI-04-V EIR-04-V	4	10.06[.396]	7.62[.300]
EI-05-V EIR-05-V	5	12.60[.496]	10.16[.400]
EI-06-V EIR-06-V	6	15.14[.596]	12.70[.500]
EI-07-V EIR-07-V	7	17.68[.696]	15.24[.600]
EI-08-V EIR-08-V	8	20.22[.796]	17.78[.700]
EI-09-V EIR-09-V	9	22.76[.896]	20.32[.800]
EI-10-V EIR-10-V	10	25.3[0.996]	22.86[.900]
EI-12-V EIR-12-V	12	30.38[1.196]	27.94[1.100]

Schematic(TYP.)



(1,2,3,4,5,6,7,8,9,10,12,POS AVAIL)

DIMENSIONS

ES(R)-V

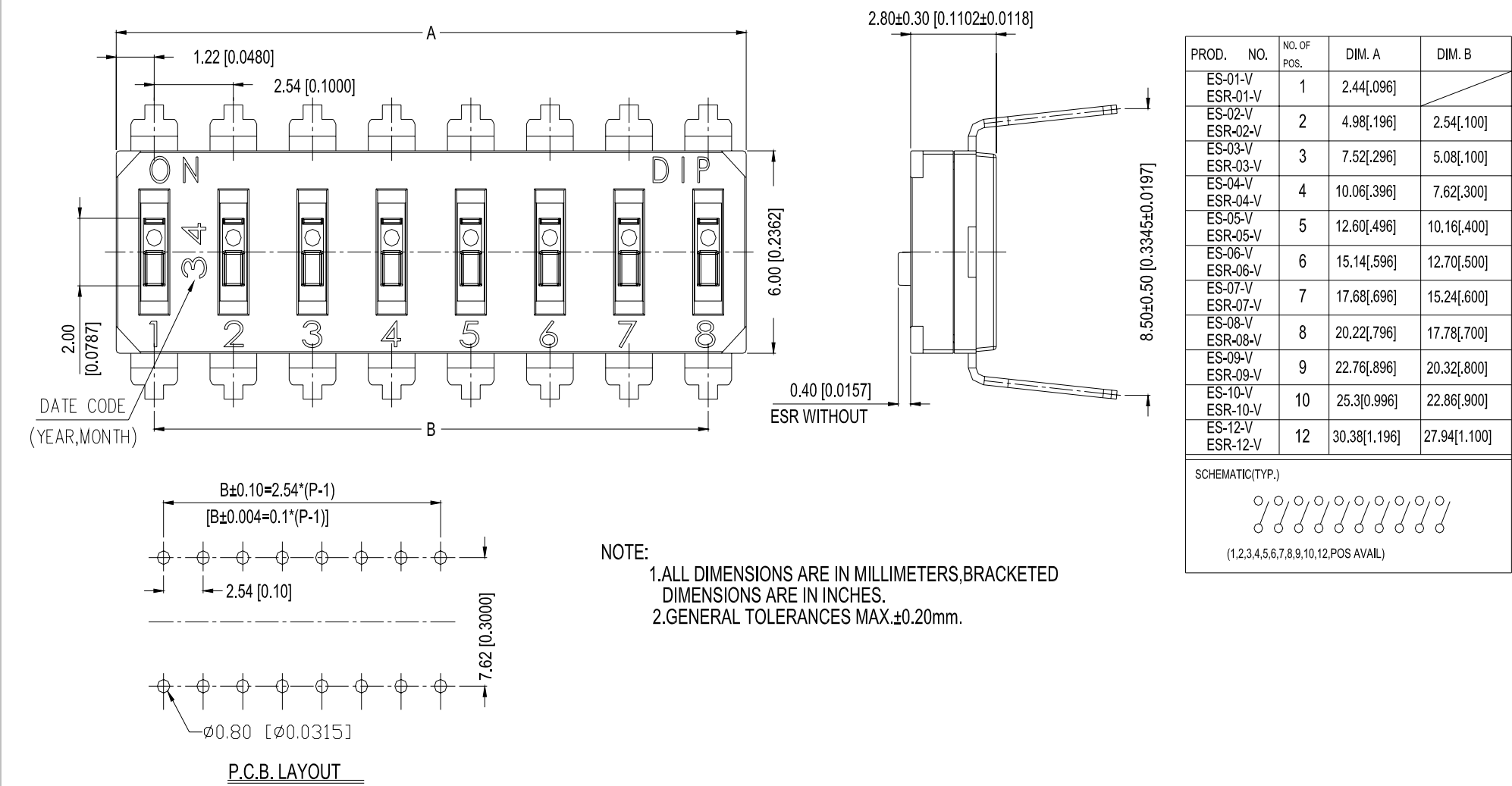

HOW TO ORDER

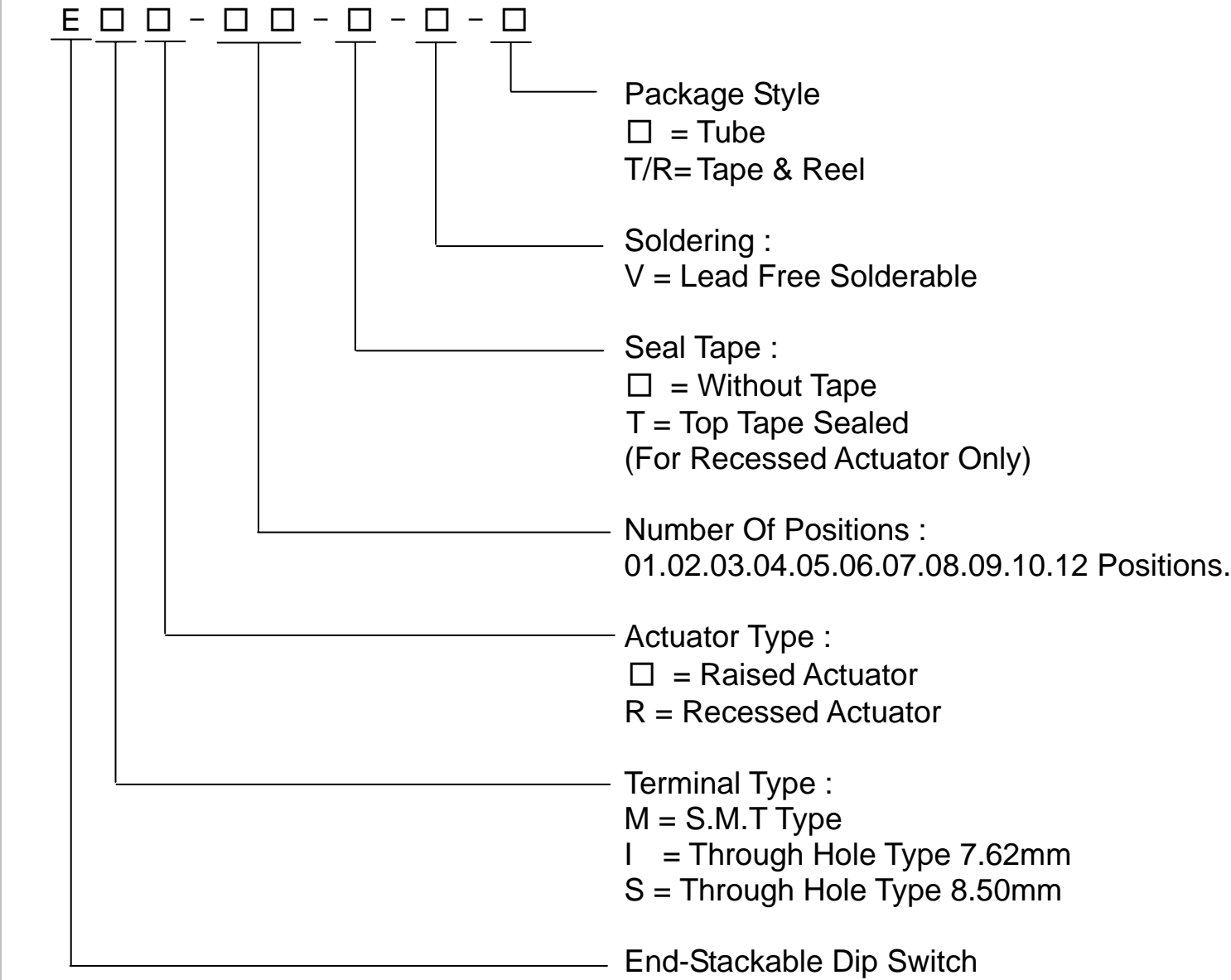

SPECIFICATION

△MECHANICAL

Mechanical Life: 2,000 operations.
Operation Force: 1,000gf max.
Stroke: 1.0 mm
Operation Temp: -20℃ to +85℃
Storage Temperature: -40℃ to +85℃

△ELECTRICAL

Electrical Life: 2,000 cycles.
Rating: 25 mA,24 VDC.
Contact resistance: 100mΩ min. at 500VDC.
Insulation Resistance: 100MΩ max, at 500 VDC.
Dielectric Strength: 500VAC/1 minute.
Contact Arrangement 1 pole throw.

MATERIAL

△BASE & COVER: UL94V-0 Nylon High-Temp Thermoplastic. Color: Black.
△ACTUATOR: UL94V-0 LCP High-Temp Thermoplastic. Color: White.
△CONTACT: Alloy Copper with gold plated.
△TERMINAL: Brass with gold plated.
△TAPE: Kapton.

SOLDERING PROCESSES

△WAVE SOLDERING: Recommended solder temperature at 500°F(260℃) max. of 5 seconds for through hole type.
△HAND SOLDERING: Use a soldering iron of 30 watts, controlled at 350℃ approximately max 5 seconds while applying.
△REFLOW SOLDERING: When applying reflow soldering, the peak temperature or the reflow Oven should be set at 260℃ max.
△Do not wash the switch except top tape sealed type, which suitable for spray cleaning method from top of the s/w.
△Reflow Temperature Profile:

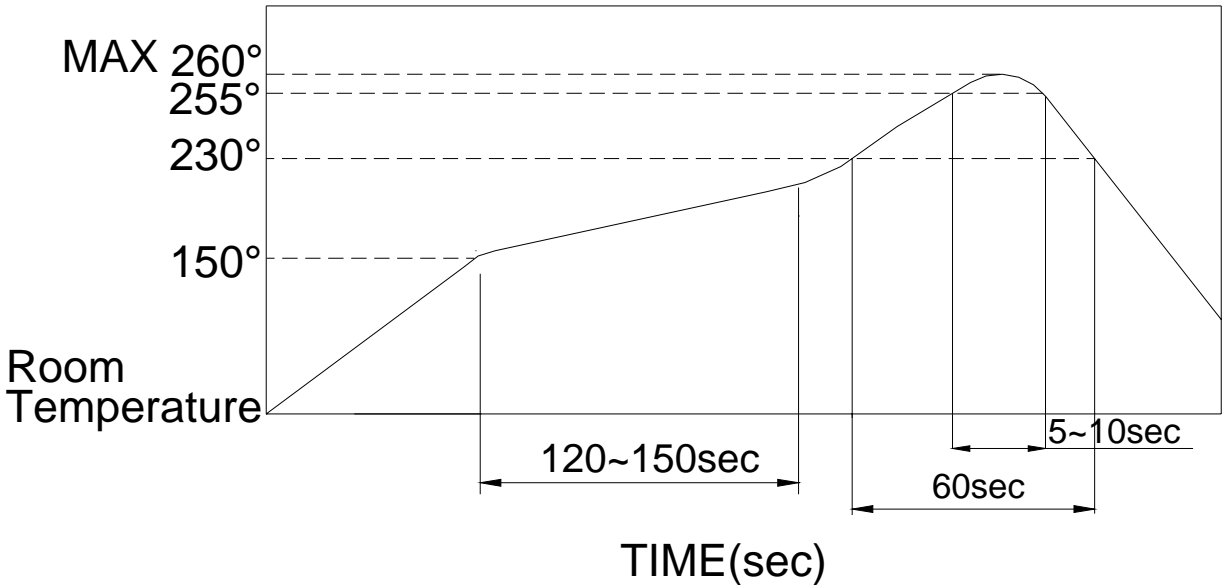

PACKING

Part Number	Number Per Tube	Number Per Reel
EM、EI(R)-01	194	-
EM、EI(R)-02	95	-
EM、EI(R)-03	63	-
EM、EI(R)-04	47	-
EM、EI(R)-05	38	-
EM、EI(R)-06	31	-
EM、EI(R)-07	27	-
EM、EI(R)-08	23	-
EM、EI(R)-09	21	-
EM、EI(R)-10	18	-
EM、EI(R)-12	12	-
EM(R)-01、02、03	-	900
04、05、06、		
07、08、09、		
10、12、		

EM(R) REEL

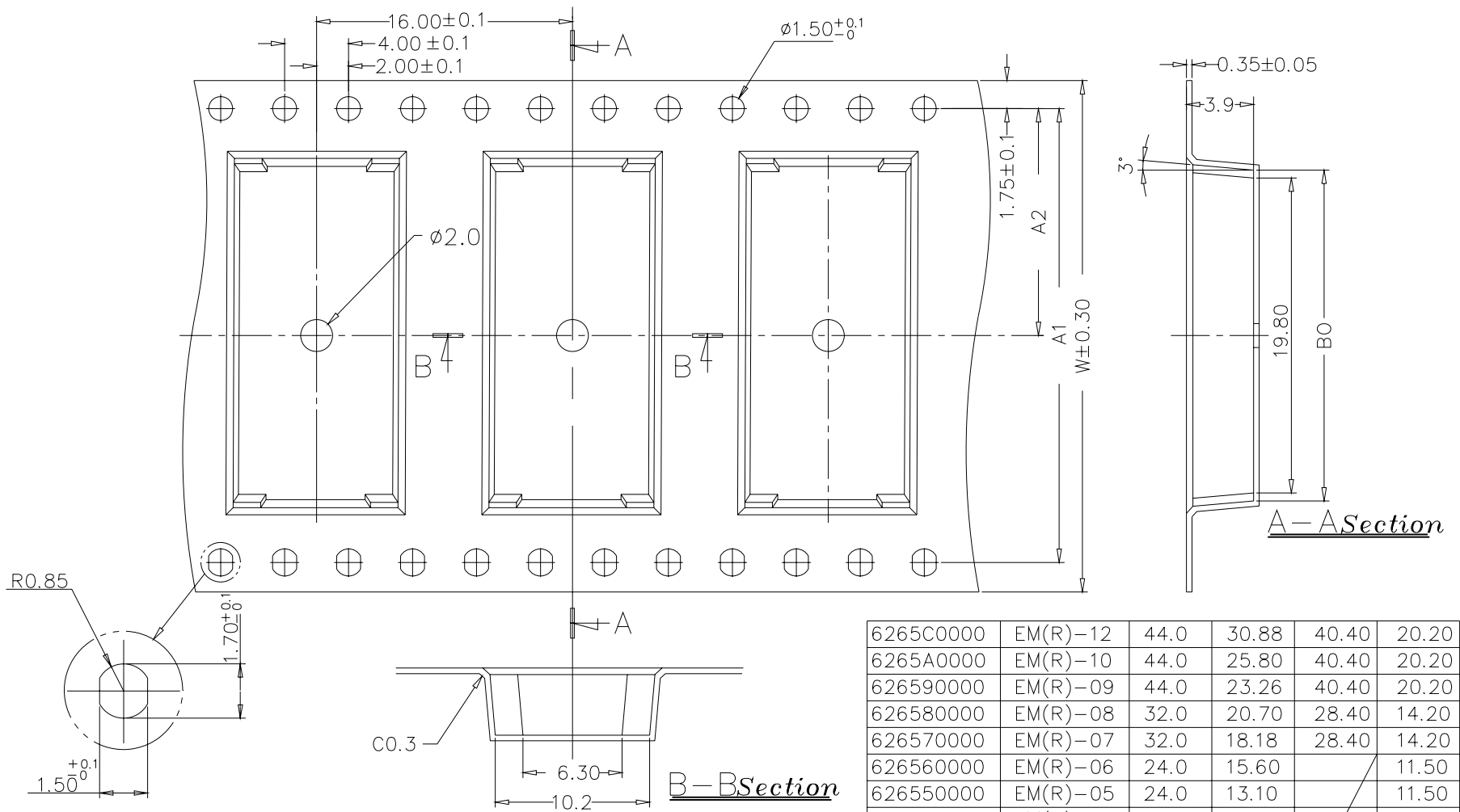

- 1. General Tolerance : $\pm 0.10\text{mm}$
- 2. Carrier with bilateral holes is applied when carrier width is 32mm and above.
- 3. The diameter of the detection hole is 2.0mm for carrier width 32mm and above, while 1.5mm for carrier width under 32mm

EM(R) TUBE

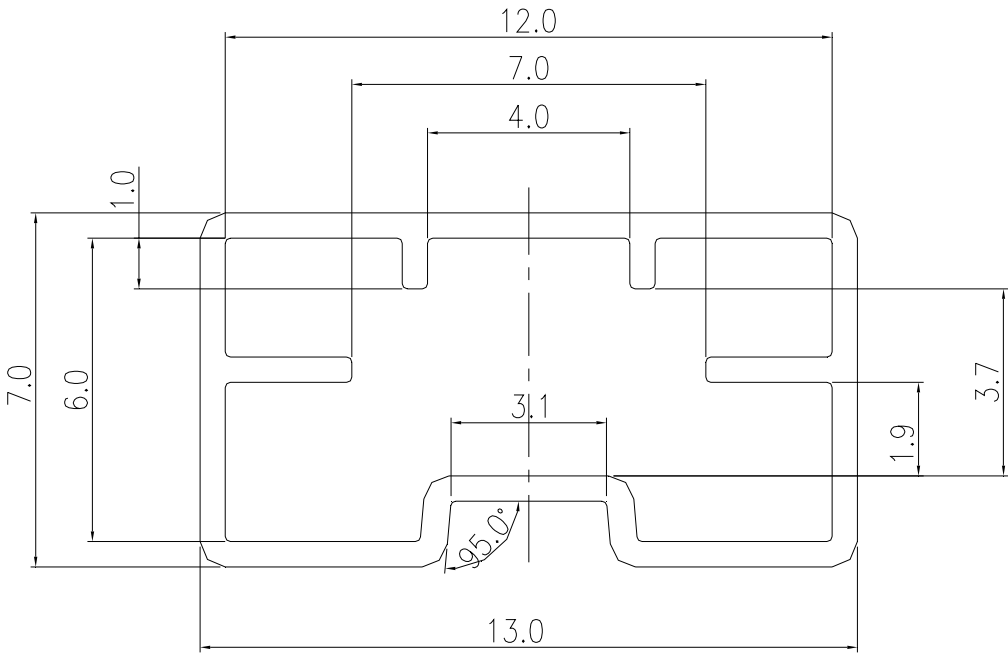

General Tolerance : $\pm 0.20\text{mm}$

EII(R) TUBE

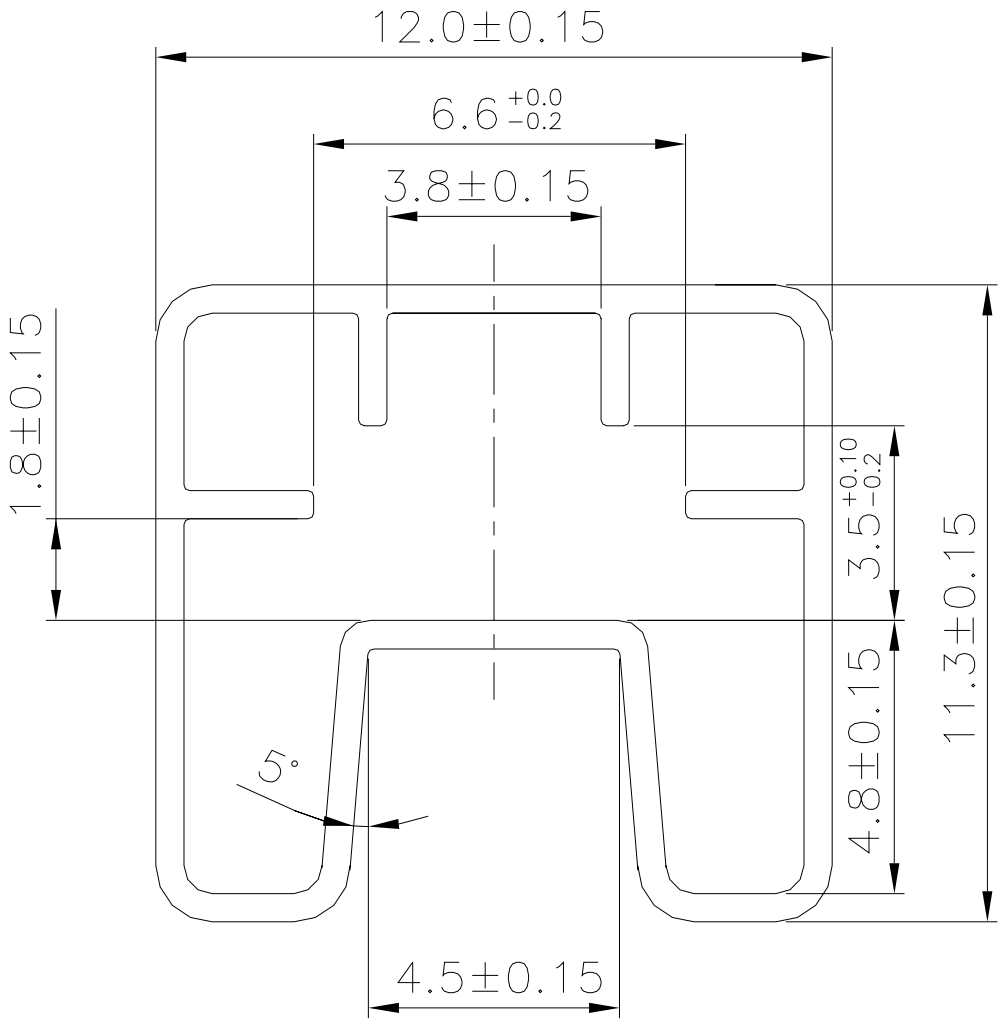

General Tolerance : $\pm 0.20\text{mm}$