

# TII(R) & TIM(R) SERIES

## DIMENSIONS

### TIM(R)

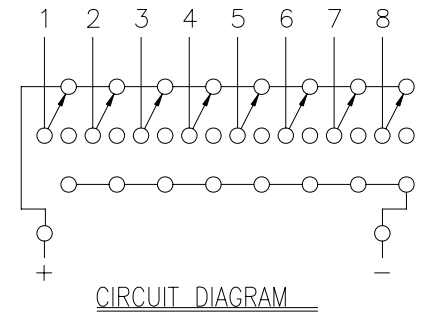
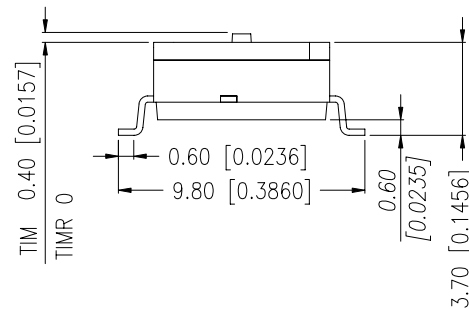
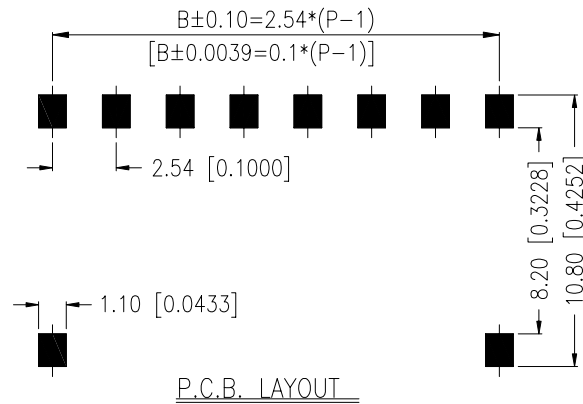
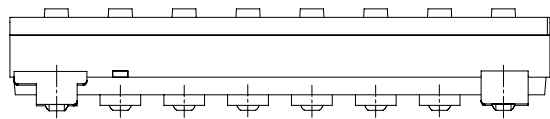
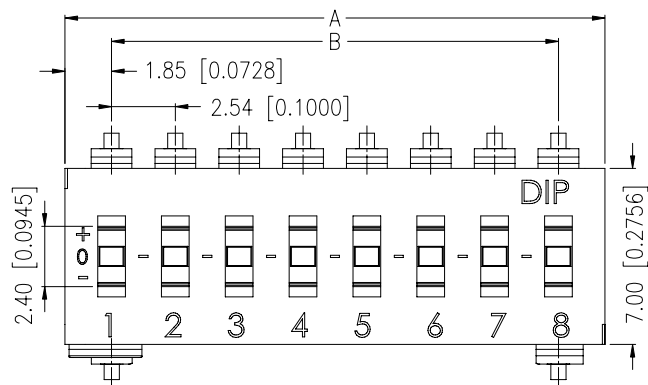

TIM-10	10	26.56[1.046]	22.86[.900]
TIMR-10	10	26.56[1.046]	22.86[.900]
TIM-09	9	24.02[.946]	20.32[.800]
TIMR-09	9	24.02[.946]	20.32[.800]
TIM-08	8	21.48[.846]	17.78[.700]
TIMR-08	8	21.48[.846]	17.78[.700]
TIM-04	4	11.32[.446]	7.62[.300]
TIMR-04	4	11.32[.446]	7.62[.300]
PROD. NO.	NO. OF POS.	DIM. A	DIM. B

General Tolerance : ±0.2mm

### TII(R)

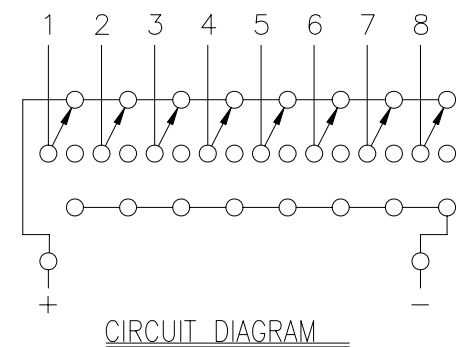
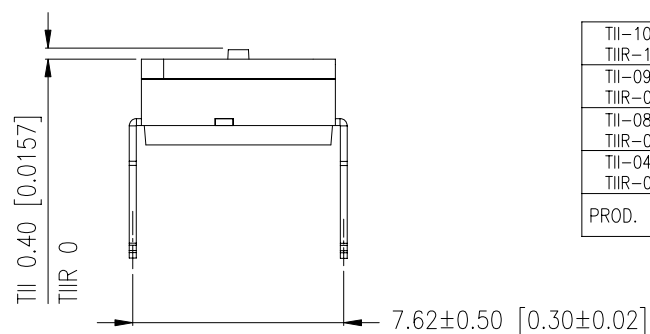
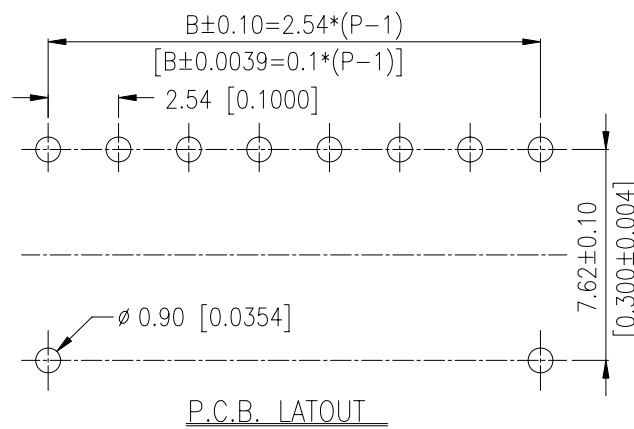
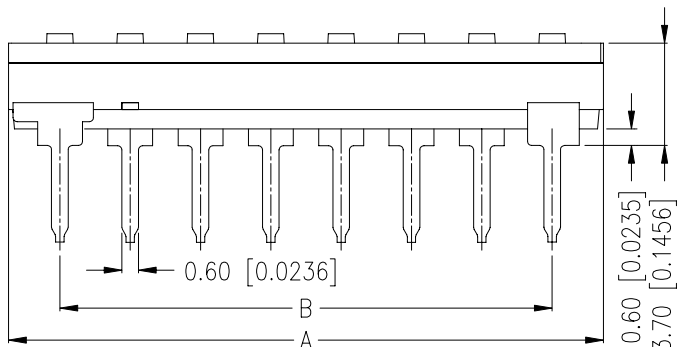
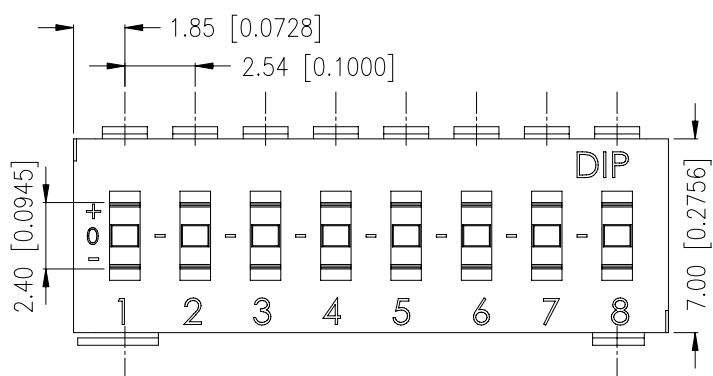

TII-10	10	26.56[1.046]	22.86[.900]
TIIIR-10	10	26.56[1.046]	22.86[.900]
TII-09	9	24.02[.946]	20.32[.800]
TIIIR-09	9	24.02[.946]	20.32[.800]
TII-08	8	21.48[.846]	17.78[.700]
TIIIR-08	8	21.48[.846]	17.78[.700]
TII-04	4	11.32[.446]	7.62[.300]
TIIIR-04	4	11.32[.446]	7.62[.300]
PROD. NO.	NO. OF POS.	DIM. A	DIM. B

General Tolerance : ±0.2mm

HOW TO ORDER

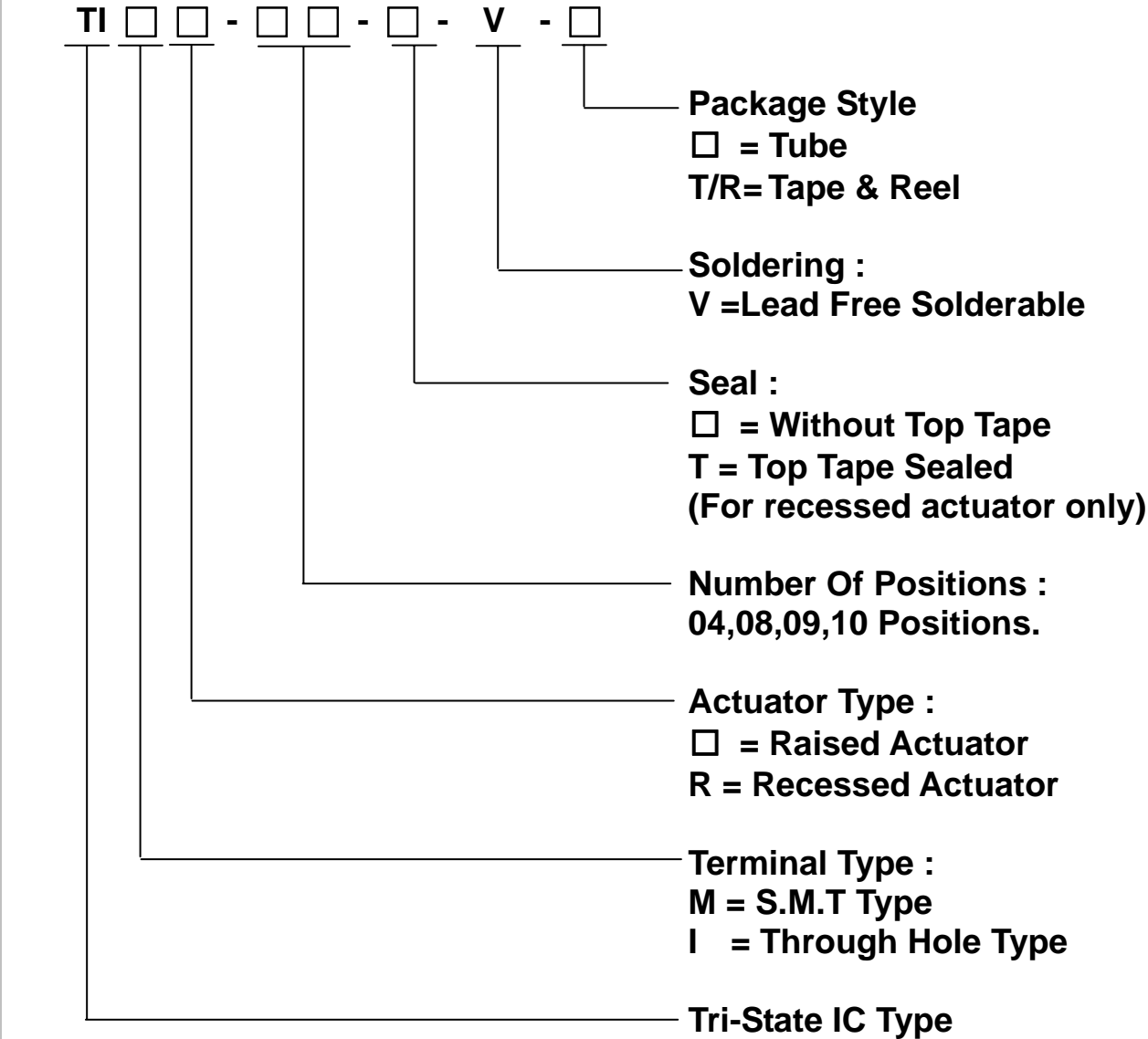

SPECIFICATION

△MECHANICAL  
Mechanical Life: 2,000 operations.  
Operation Force: 1,000gf max.  
Stroke: 0.8 mm  
Operation Temp: -20℃ to +85℃  
Storage Temperature: -40℃ to +85℃

△ELECTRICAL  
Electrical Life: 2,000 cycles.  
Rating: 25 mA,24 VDC.  
Contact resistance: 100mΩ max.  
Dielectric Strength: 500VAC/1 minute.  
Circuit: 3 switching positions.

MATERIAL

△BASE & COVER: UL94V-0 Nylon High-Temp Thermoplastic. Color: Black.  
△ACTUATOR: UL94V-0 LCP High-Temp Thermoplastic. Color: White.  
△CONTACT: Alloy Copper with gold plated.  
△TERMINAL: Brass with gold plated.  
△TAPE: KAPTON.

SOLDERING PROCESSES

- For best results, please follow these recommendation :
- △ WAVE SOLDERING : Recommended solder temperature at 500°F(260℃) max. 5 seconds for through hole type.
  - △ HAND SOLDERING : Use a soldering iron of 30 watts, controlled at 350℃ approximately max 5 seconds while applying.
  - △ REFLOW SOLDERING : When applying reflow soldering, the peak temperature or the reflow oven should be set at 260℃ max.
  - △ Do not wash the switch body except top tape sealed type, which suitable for spray cleaning method from top of the s/w.
  - △ Any flux enters the switch may fail the conductivity.
  - △ Reflow Temperature Profile :

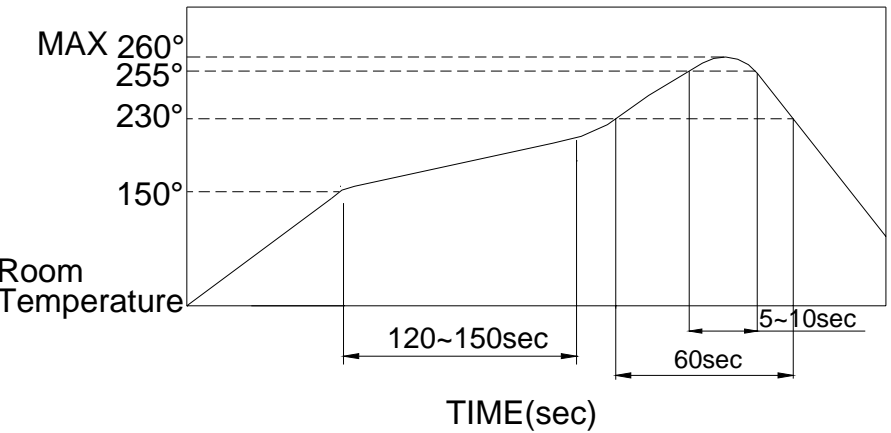

PACKING

PART NUMBER	Number Per Tube	Number Per Reel
TII(R)-04	41	-
TIM(R)-04		
TII(R)-08	22	-
TIM(R)-08		
TII(R)-09	20	-
TIM(R)-09		
TII(R)-10	18	-
TIM(R)-10		
TII(R)-04.08 09.10	-	900
TIM(R)-04.08 09.10		

TIM(R) TUBE

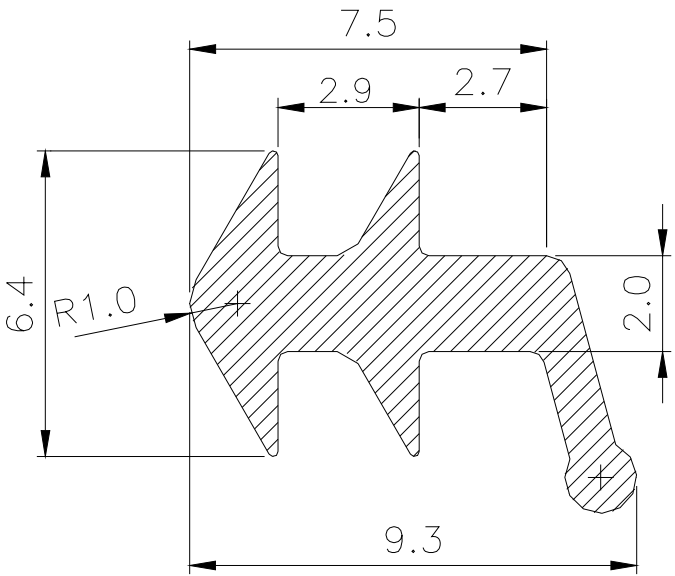
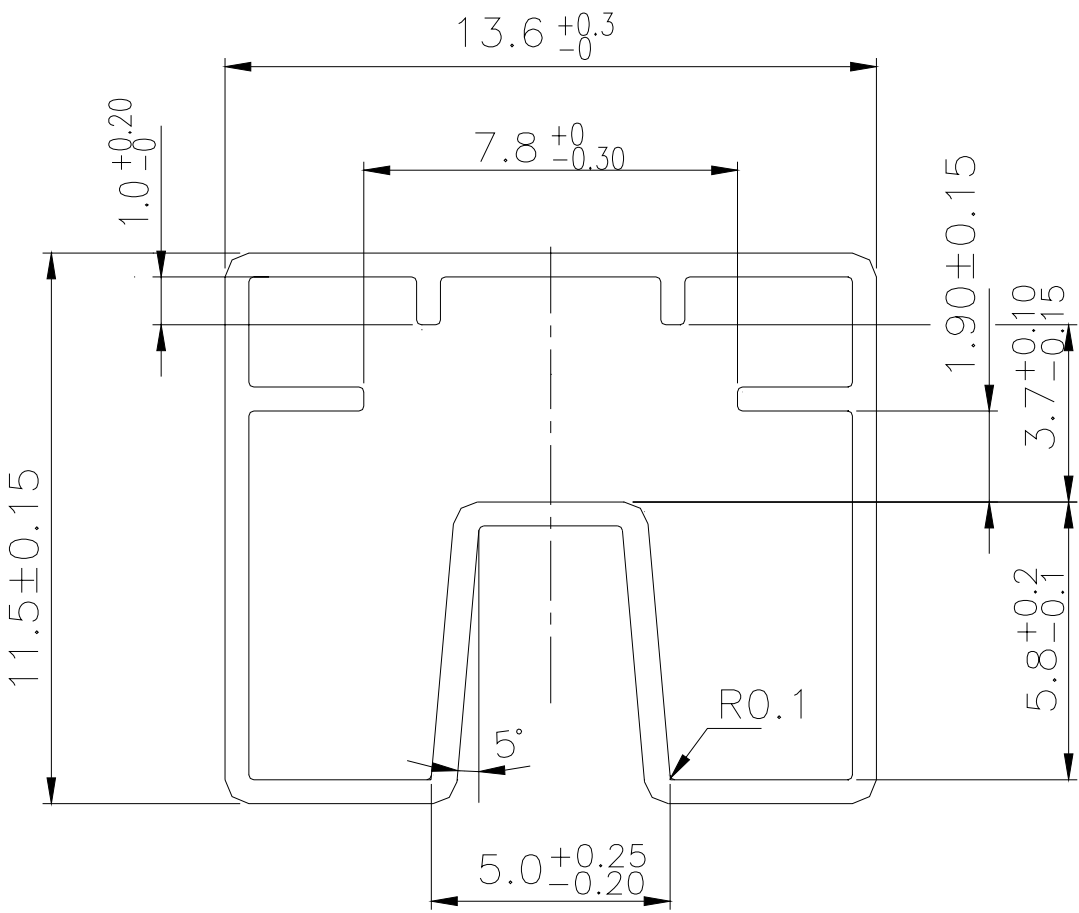

General Tolerance :  $\pm 0.2\text{mm}$

TII(R) TUBE

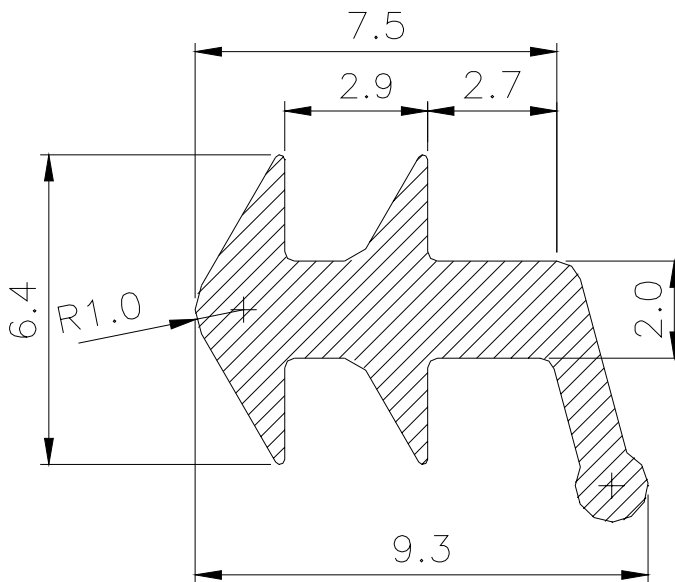
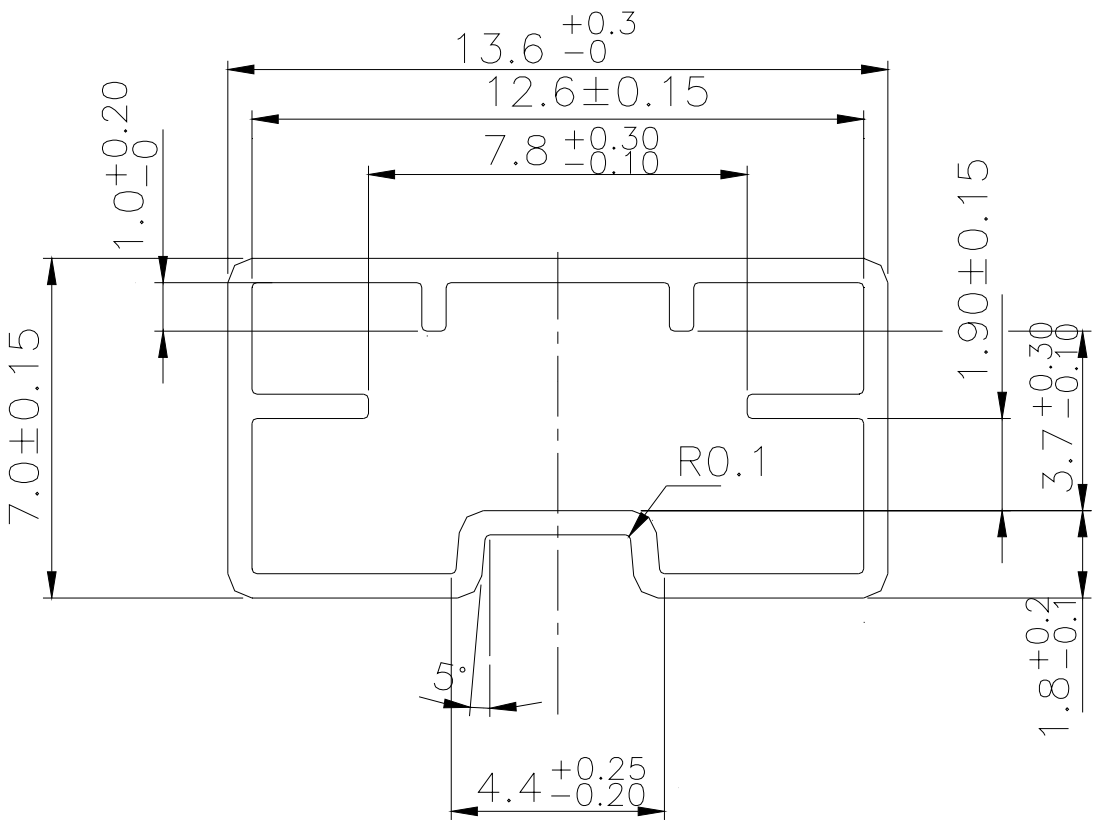

General Tolerance :  $\pm 0.2\text{mm}$

TIM(R)-04 REEL

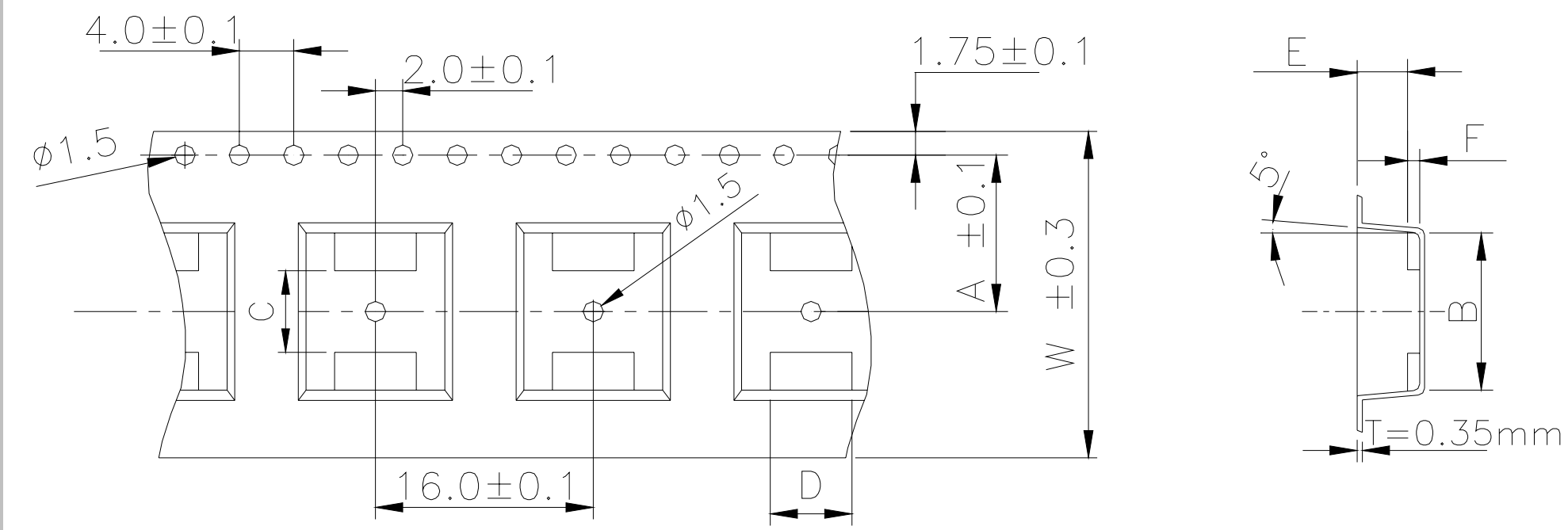

- 1. Pitch Tolerance Over Any 10  $\pm 0.20$ .
- 2. Material: PS Black-Thickness :  $0.35 \pm 0.05 \text{ mm}$ .
- 3. General Tolerances :  $\pm 0.10 \text{ mm}$ .

附註								
DMR-06	620160000	$24 \pm 0.3$	$11.5 \pm 0.1$	$16.60 \pm 0.1$	$6 \pm 0.1$	$6 \pm 0.1$	3.5	0.9
DMR-05	620150000	$24 \pm 0.3$	$11.5 \pm 0.1$	$14.15 \pm 0.1$	$3 \pm 0.1$	$6 \pm 0.1$	4.5	0.4
DMR-04.TIM-04	620140000	$24 \pm 0.3$	$11.5 \pm 0.1$	$11.56 \pm 0.1$	$6 \pm 0.1$	$6 \pm 0.1$	3.5	0.9
DMR-03	620130000	$24 \pm 0.3$	$11.5 \pm 0.1$	$9.07 \pm 0.1$	$3 \pm 0.1$	$6 \pm 0.1$	4.5	0.4
DMR-02	620120000	$16 \pm 0.3$	$7.5 \pm 0.1$	$6.50 \pm 0.1$	$3 \pm 0.1$	$6 \pm 0.1$	3.5	0.9
PART NAME	PART NO:	$W \pm 0.3$	A	B	C	D	E	F

General Tolerance :  $\pm 0.1 \text{ mm}$

TIM(R)-08.09.10 REEL

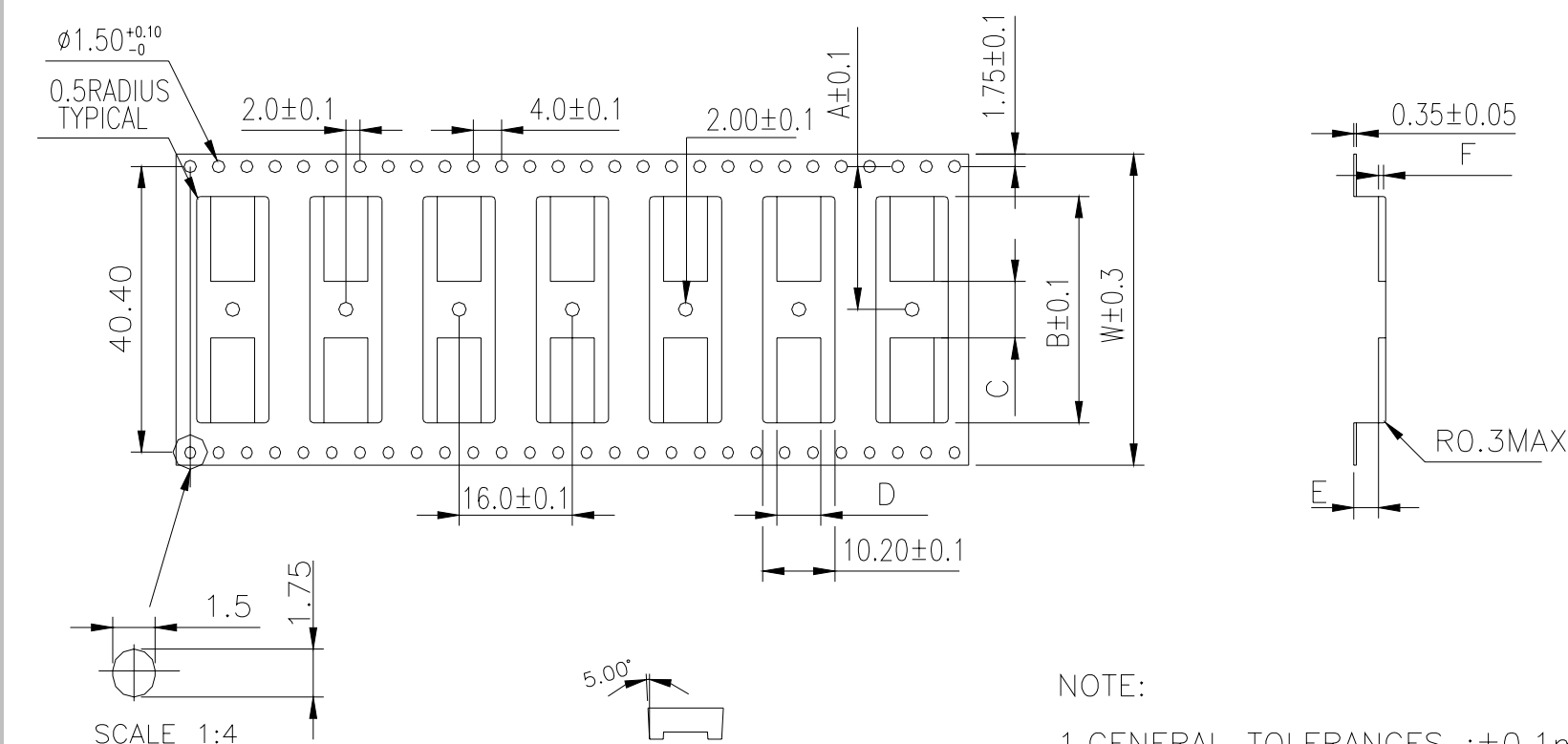

NOTE:  
1.GENERAL TOLERANCES :  $\pm 0.1 \text{ mm}$ .

附註								
DMR-12	6201C0000	44.00	20.20	32.00	8.00	6.20	3.45	1.0
DMR-10	6201A0000	44.00	20.20	26.80	5.0	6.00	4.5	0.4
TIM.DMR-09	620190000	44.00	20.20	24.26	5.00	6.00	4.5	0.4
TIM.DMR-08	620180000	32.00	14.20	21.70	6.00	6.00	3.5	0.9
DMR-07	620170000	32.00	14.20	19.20	5.00	6.00	4.5	0.4
PART NAME	PART NO.	$W \pm 0.3$	A	B	C	D	E	F

General Tolerance :  $\pm 0.1 \text{ mm}$